

AL-4·4S

Features

1. Safety valve, simple structure and easy maintenance.
2. Easy adjustment.

Specifications

●AL-4

Structure		Open type
Application		Steam
Working pressure		0.05-1.5 MPa *1
Maximum temperature		220°C
Material	Valve case	Ductile cast iron
	Spring case	Ductile cast iron
	Valve, valve seat	Stainless steel
Connection		JIS 10K FF flanged JIS 16K FF flanged *2

*1 Maximum working pressure for 150A type is 0.8 MPa (connection: JIS 10K FF flanged).

*2 JIS 16K FF flanged when working pressure is more than 1.0 MPa.

●AL-4S

Structure		Open type
Application		Steam
Working pressure		0.05-2.0 MPa
Maximum temperature		220°C
Material	Valve case	Ductile cast iron
	Spring case	Ductile cast iron *
	Valve, valve seat	Stainless steel
Connection		JIS 10K FF flanged JIS 16K FF flanged JIS 20K FF flanged

* Available with stainless steel made.

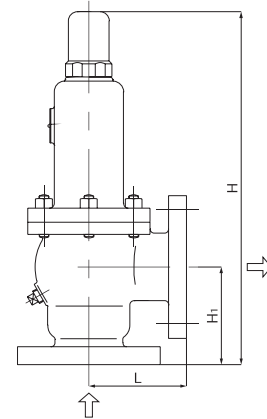

Dimensions and Weights

●AL-4 (JIS 10K)

Nominal size	Dimension (mm)				Flow area $\pi D \ell$ (mm ²)	Weight (kg)
	L	H ₁	H	Seat diameter		
65A	120	120	432	65	331.9	20
80A	130	130	447	75	441.8	22
100A	160	150	595	100	785.4	44
125A	200	205	779	125	1227.2	88
150A	210	215	835	150	1767.2	113

●AL-4 (JIS 16K)

Nominal size	Dimension (mm)				Flow area $\pi D \ell$ (mm ²)
	L	H ₁	H	Seat diameter	
65A	120	120	432	65	331.9
80A	132	130	449	75	441.8
100A	162	150	597	100	785.4
125A	202	205	781	125	1227.2

●AL-4S

Nominal size	Dimension (mm)				Flow area $\pi D \ell$ (mm ²)
	L	H ₁	H	Seat diameter	
65A	135	125	442	65	331.9
80A	135	135	457	75	441.8
100A	160	150	597	100	785.4